

# U012

## Mounting Instructions

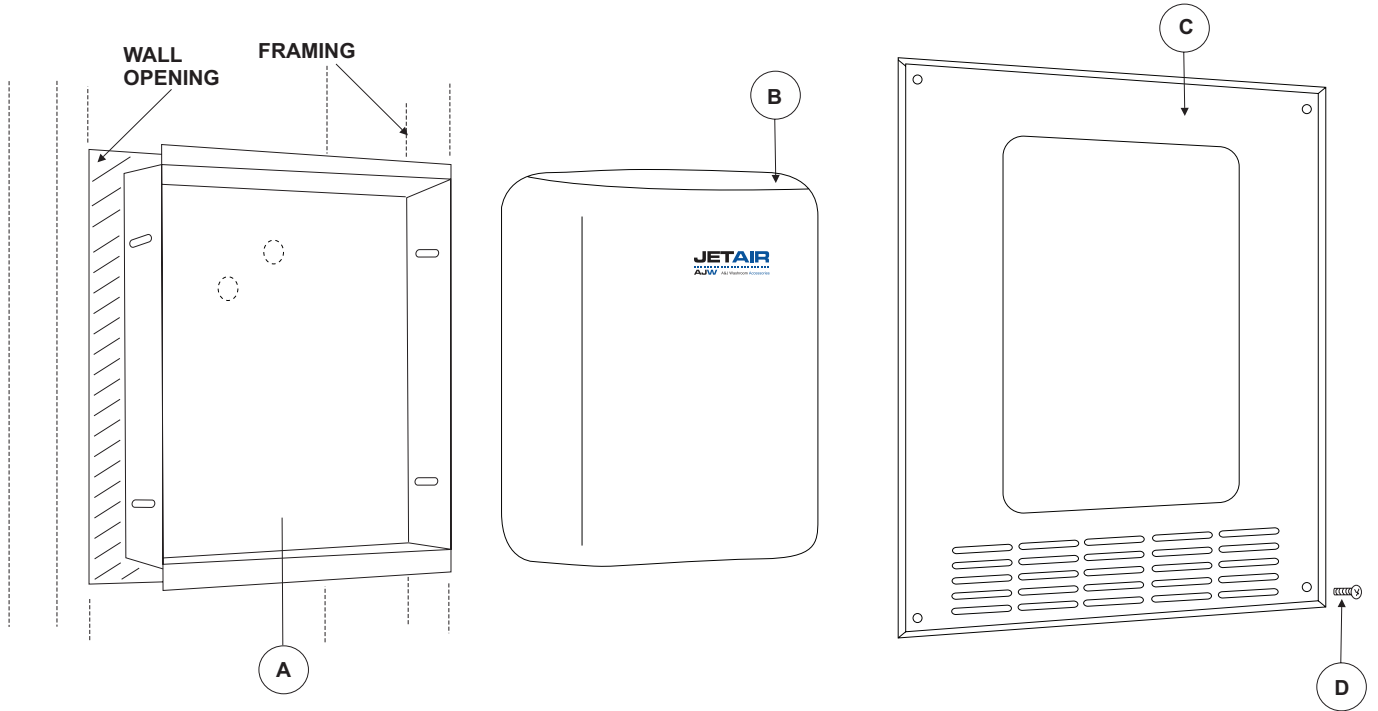

### PARTS LIST

- A. Recessing Box
- B. Dryer
- C. Face Plate
- D. Fastner

### INSTRUCTIONS

1. Provide a rough wall opening 11 1/4"W x 15 3/4"H x 3 1/2"D
2. Select the proper knockout location for each application.
3. Secure box in wall opening with proper fasteners
4. Have qualified, licensed electrician run electrical connection through knockout location
5. Secure base to recessing box and connect power to dryer
6. Test dryer operation
7. Secure dryer cover and test dryer again
8. Secure face plate